

CARPORT

General Information

A permit is required for the installation of a carport. A carport shall be permitted provided that such carport is not located in a required front or side yard, not less than five (5) feet from the rear property line, and fully open on two sides, one of which is the entrance side. If a contractor is used, that contractor must be registered in the City of Lewisville and a [contractor application](#) must be completed and submitted to Building Inspections.

Plans submittal requirements

1. A copy of the Plot plan or survey plat (1" = 20' scale) of the property that shows the property lines, house, easements, and the location of carport with dimensions.
2. A copy of construction detail scaled to 1/4" or 1/8" with material list and dimensions proposed to use.

Inspections

An inspection will be required upon completion of work. Once the work is complete, the contractor shall request a final inspection through our [online inspection request](#) portal.

Fees and Applications

A permit fee is required, and an [online application](#) must be completed and submitted to Building Inspections. Building Inspections can be contacted at (972) 219-3470 for additional information.

Example of Plot Plan:

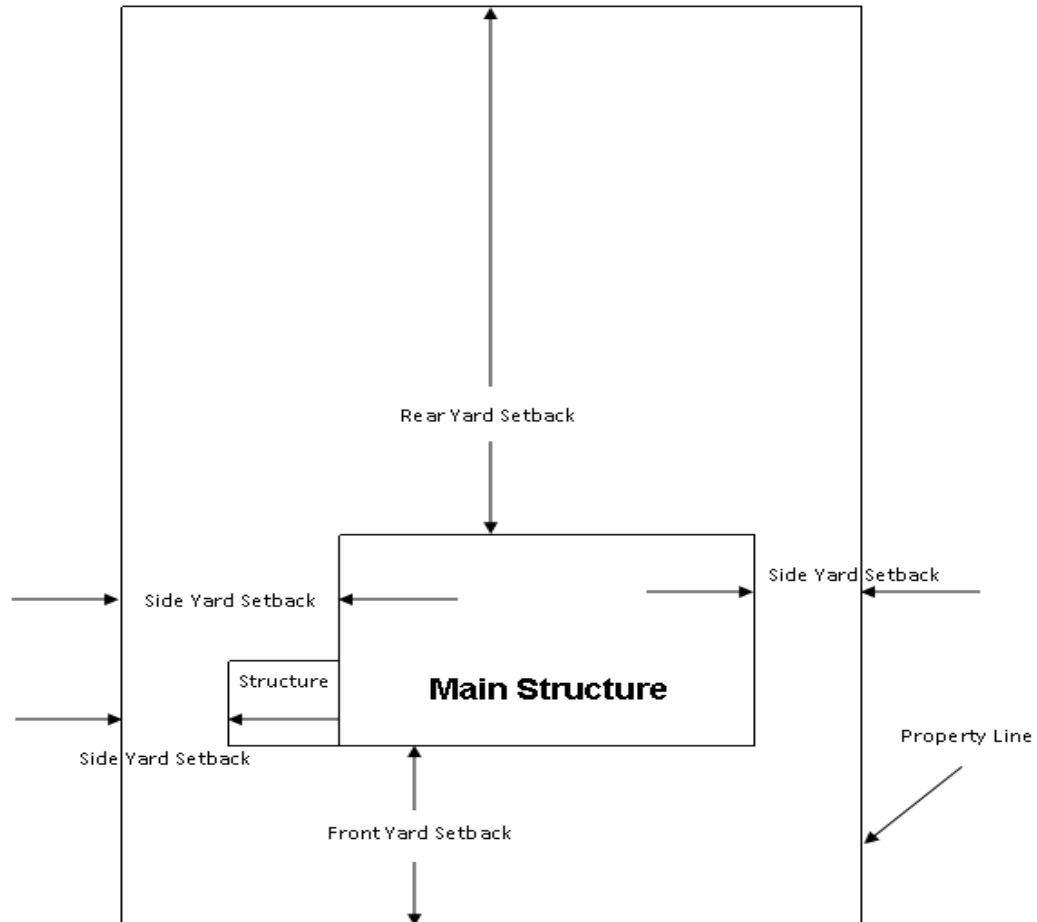

Also Include:

- * All Property line measurements
- * Any Existing Structures or pools
- * Any Easements
- * Driveway outline

Scale 1" = 20'