

SECTION "A-A"

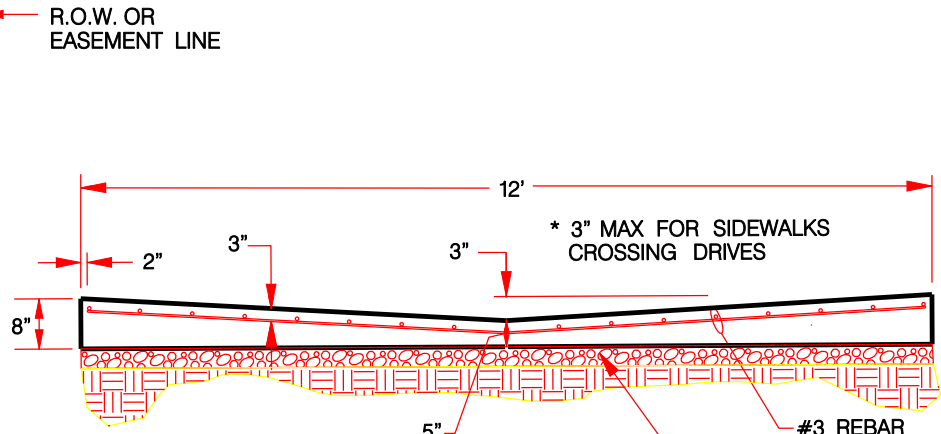

SECTION "B-B"

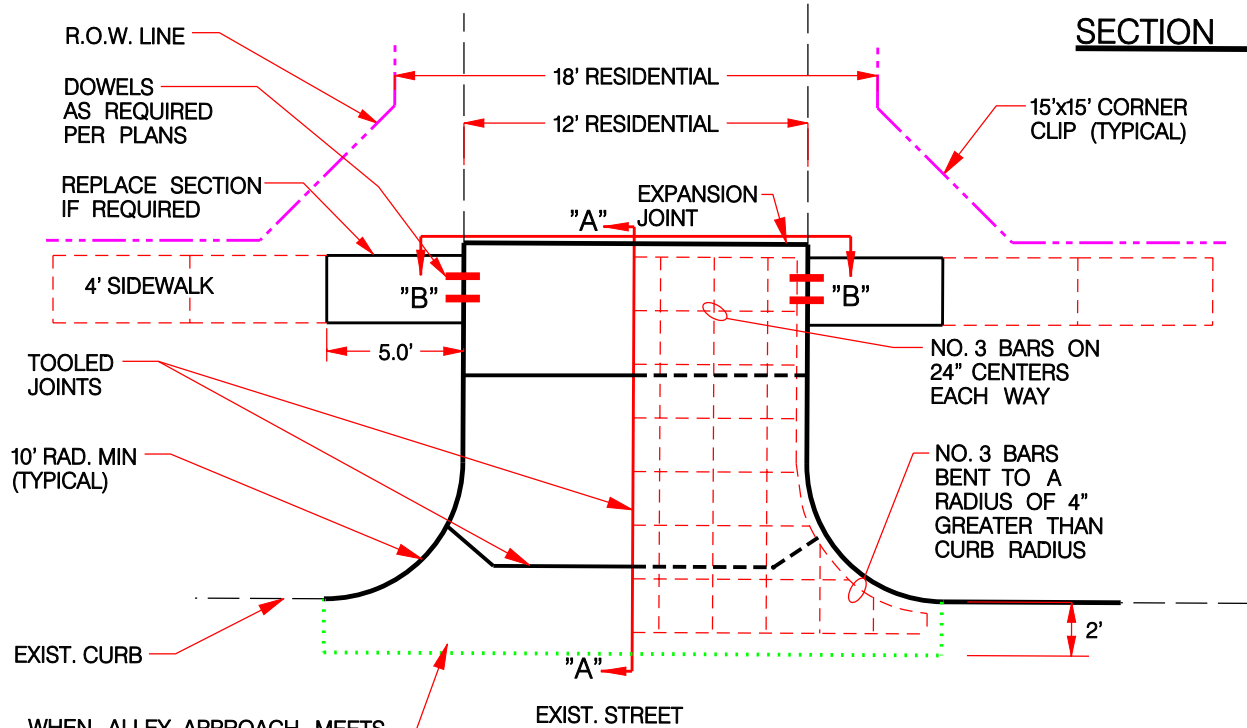

PLAN VIEW

NOTE:
DETAIL SUBJECT TO CHANGE PER DIRECTION
OF CITY OF LEWISVILLE ENGINEERING DIVISION.



Standard Details
Typical Alley Turnout
onto Residential Streets

Revisions:

No.	Description	Date

Department of
Community
Development

Office No. 972-219-3490
Fax No. 972-219-3487
www.cityoflewisville.com

Dated: 4-27-10
Sheet: 3.1

NOTE:

MAX SLOPE ON DRIVEWAY SHALL NOT EXCEED 8% UP TO R.O.W. LINE AND 14% BEYOND THE R.O.W. LINE.

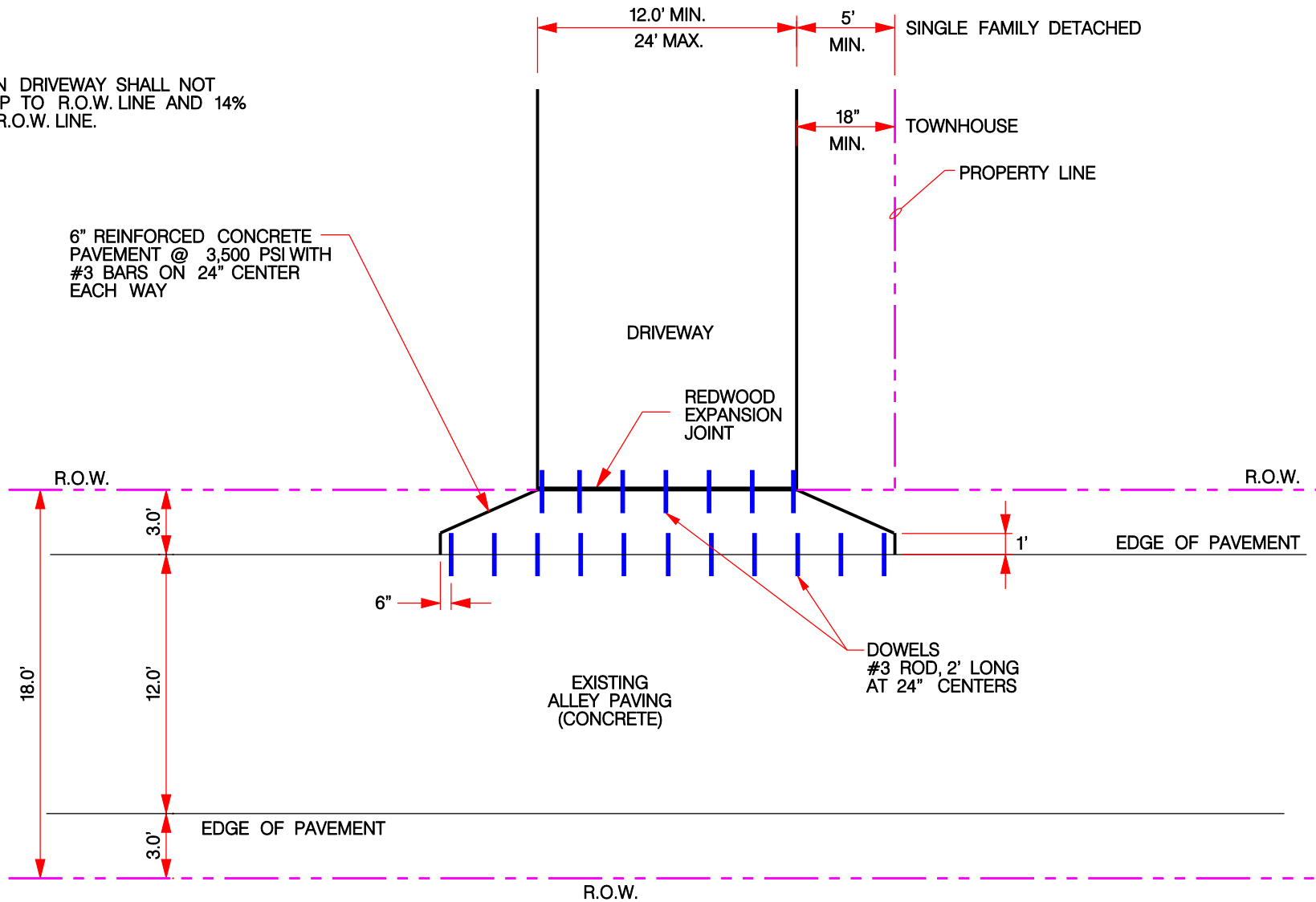

NOTE:
DETAIL SUBJECT TO CHANGE PER DIRECTION
OF CITY OF LEWISVILLE ENGINEERING DIVISION.



Standard Details
Residential Driveway Connection
(To Alley)

Revisions:

No.	Description	Date

**Department of
Community
Development**

Office No. 972-219-3490
Fax No. 972-219-3487
www.cityoflewisville.com

Dated: 4-27-10

Sheet:
3.2

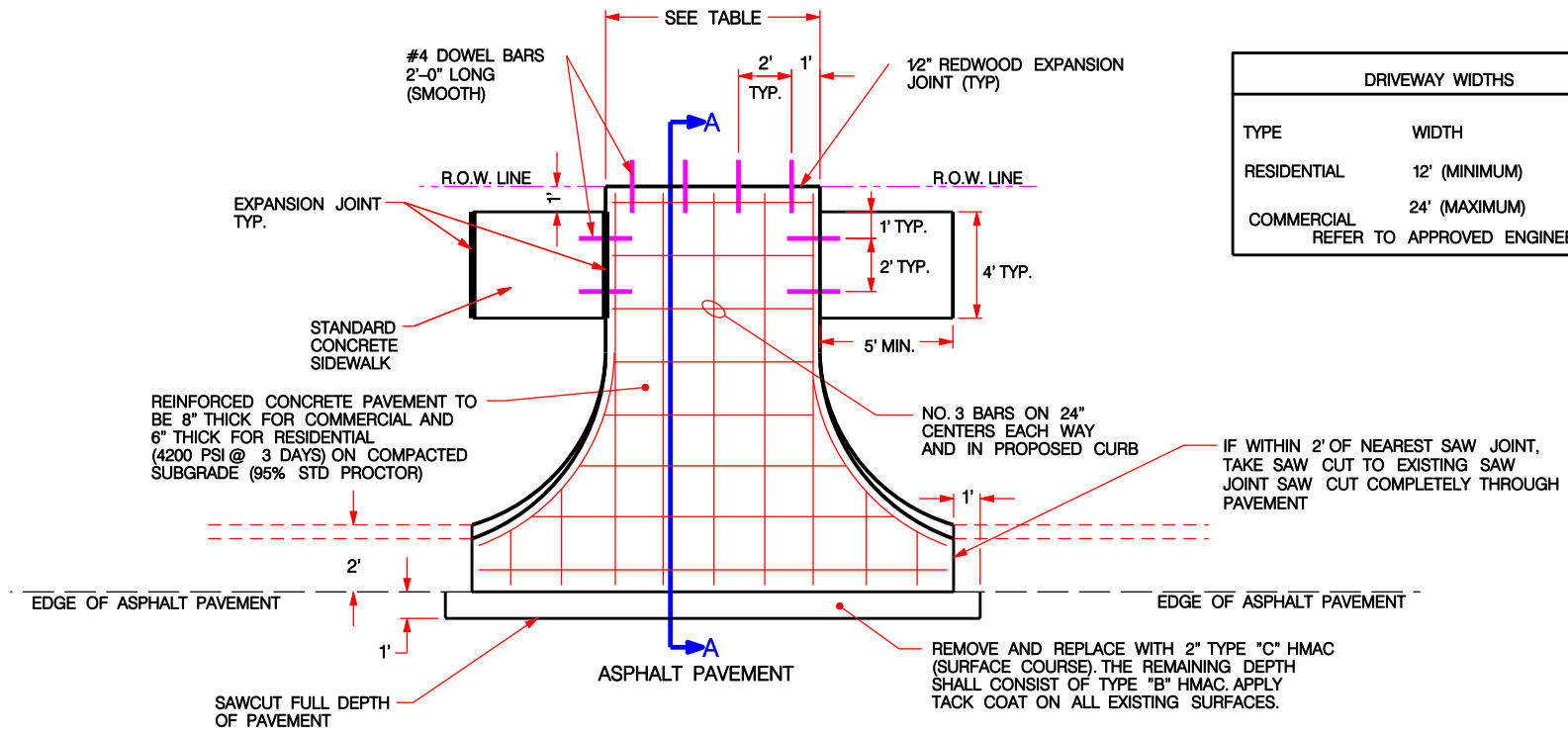

DRIVEWAY WIDTHS		
TYPE	WIDTH	RADIUS
RESIDENTIAL	12' (MINIMUM)	5'
COMMERCIAL	24' (MAXIMUM)	5'
REFER TO APPROVED ENGINEERING SITE PLAN		

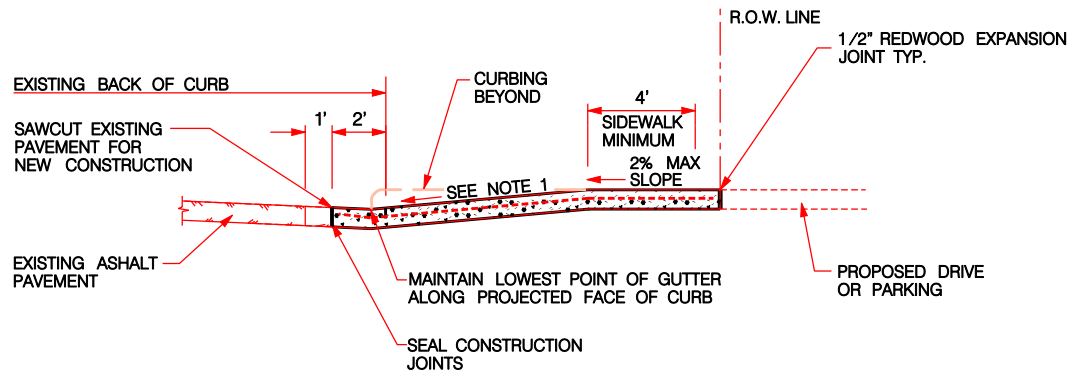

- NOTE:
1. MAXIMUM SLOPE IS 10% FOR RESIDENTIAL AND 8% FOR COMMERCIAL.
 2. DRIVEWAY TO BE CONSTRUCTED WITHIN 5 DAYS OF SAWCUTTING PAVEMENT.

A-A SECTION THROUGH DRIVE APPROACH

NOTE:
DETAIL SUBJECT TO CHANGE PER DIRECTION
OF CITY OF LEWISVILLE ENGINEERING DIVISION.



Standard Details

Driveway Paving Detail

(Concrete Drive with Asphalt Pavement)

Revisions:		
No.	Description	Date

Department of
Community
Development

Office No. 972-219-3490
Fax No. 972-219-3487
www.cityoflewisville.com

Dated: 4-27-10

Sheet:
3.3

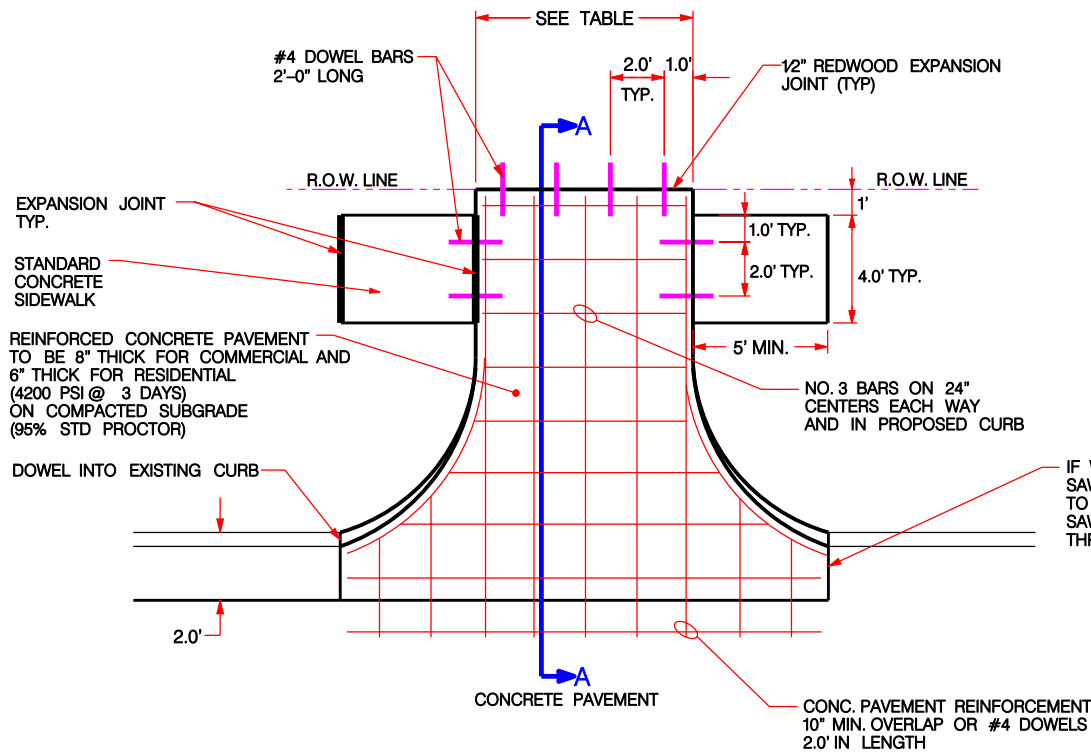

DRIVEWAY WIDTHS		
TYPE	WIDTH	RADIUS
RESIDENTIAL	12' (MINIMUM)	5'
	24' (MAXIMUM)	5'
COMMERCIAL	REFER TO APPROVED ENGINEERING SITE PLAN	

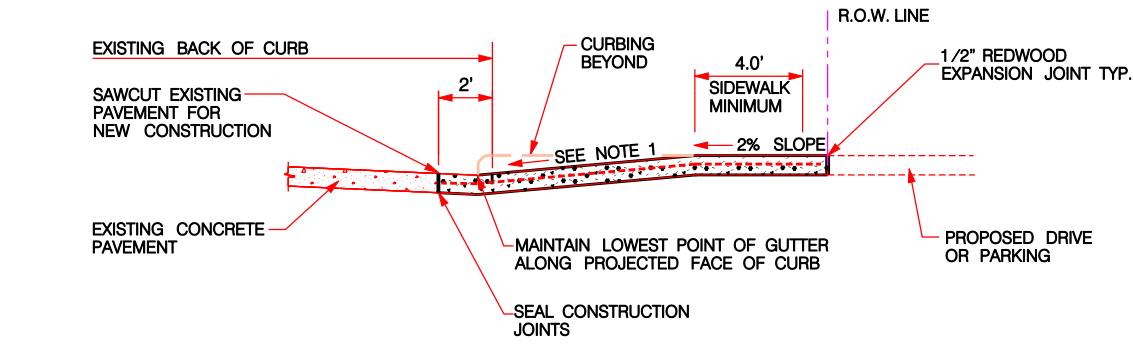

- NOTE:
1. MAXIMUM SLOPE IS 10% FOR RESIDENTIAL AND 8% FOR COMMERCIAL
 2. DRIVEWAY TO BE CONSTRUCTED WITHIN 5 DAYS OF SAW CUTTING PAVEMENT

A-A SECTION
CONCRETE DRIVE APPROACH

NOTE:
DETAIL SUBJECT TO CHANGE PER DIRECTION
OF CITY OF LEWISVILLE ENGINEERING DIVISION.



Standard Details

Driveway Paving Detail

(Concrete Drive with Concrete Pavement)

Revisions:		
No.	Description	Date

Department of Community Development		Dated: 4-27-10
Office No. 972-219-3490	Fax No. 972-219-3487	Sheet: 3.4
www.cityoflewisville.com		

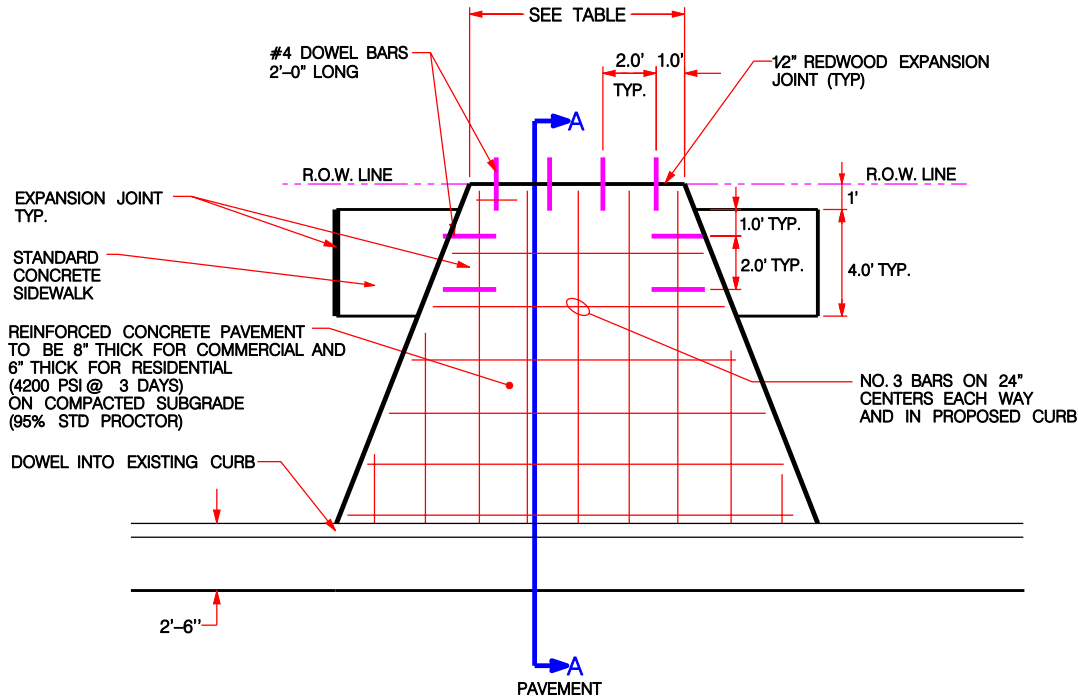

DRIVEWAY WIDTHS		
TYPE	WIDTH	FLARE
SINGLE FAMILY DETACHED	12' (MINIMUM) 24' (MAXIMUM)	5' 5'
TOWNHOUSE	12' (MINIMUM) 24' (MAXIMUM)	18" 18"
COMMERCIAL	REFER TO APPROVED ENGINEERING SITE PLAN	

REINFORCED CONCRETE PAVEMENT TO BE 8" THICK FOR COMMERCIAL AND 6" THICK FOR RESIDENTIAL (4200 PSI @ 3 DAYS) ON COMPACTED SUBGRADE (95% STD PROCTOR)

NO. 3 BARS ON 24" CENTERS EACH WAY AND IN PROPOSED CURB

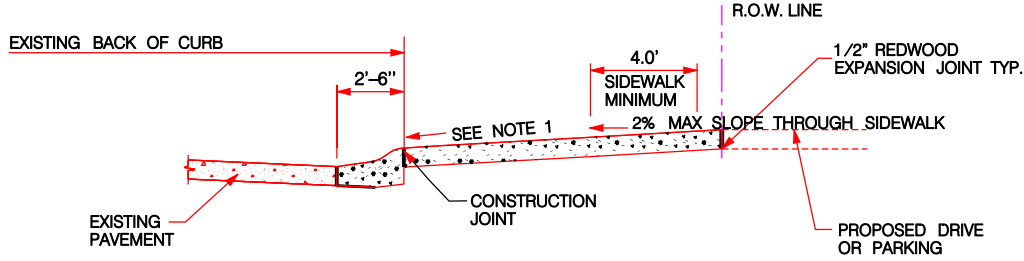

NOTE:
1. MAXIMUM SLOPE IS 8% FOR RESIDENTIAL AND FOR COMMERCIAL

A-A SECTION
CONCRETE DRIVE APPROACH

NOTE:
DETAIL SUBJECT TO CHANGE PER DIRECTION OF CITY OF LEWISVILLE ENGINEERING DIVISION.



Standard Details

Driveway Paving Detail

(Concrete Drive with Surmountable Curb)

Revisions:		
No.	Description	Date

Department of
Community
Development

Office No. 972-219-3490
Fax No. 972-219-3487
www.cityoflewisville.com

Dated: 4-27-10

Sheet:
3.5

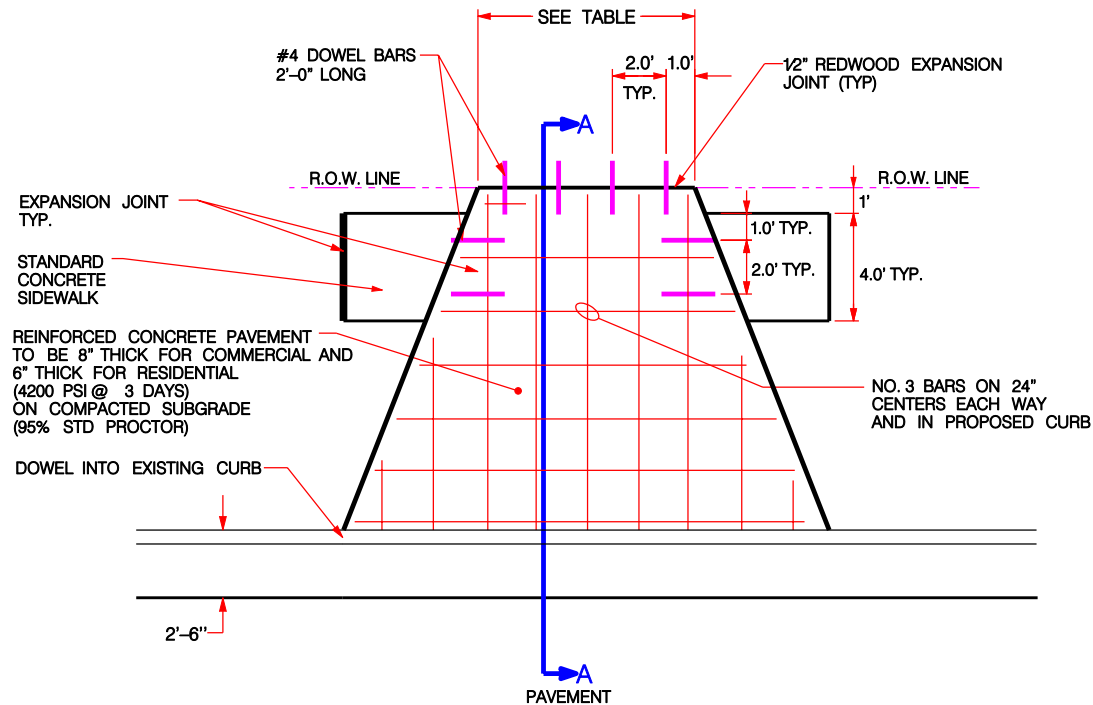

DRIVEWAY WIDTHS		
TYPE	WIDTH	FLARE
SINGLE FAMILY	12' (MINIMUM)	
DETACHED	24' (MAXIMUM)	5' 5'
TOWNHOUSE	12' (MINIMUM)	18"
COMMERCIAL	24' (MAXIMUM)	18"
REFER TO APPROVED ENGINEERING SITE PLAN		

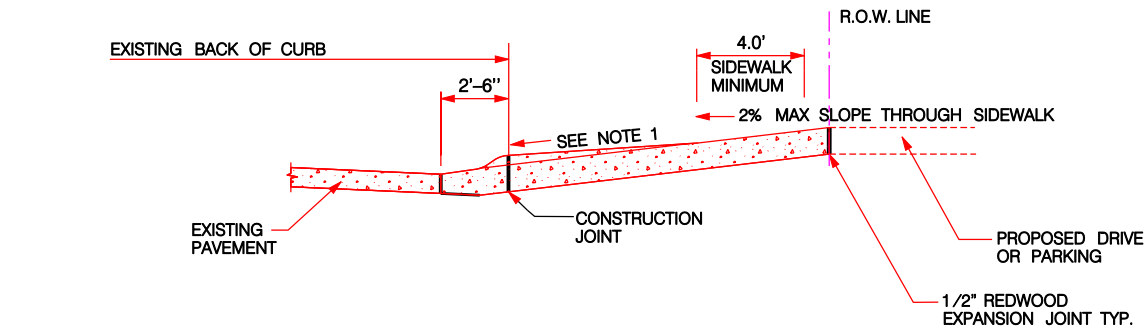

NOTE:
1. MAXIMUM SLOPE IS 8% FOR RESIDENTIAL AND FOR COMMERCIAL

A-A SECTION
CONCRETE DRIVE APPROACH

NOTE:
DETAIL SUBJECT TO CHANGE PER DIRECTION
OF CITY OF LEWISVILLE ENGINEERING DIVISION.



Standard Details

Driveway Paving Detail

(Concrete Drive with removed Surmountable Curb)

Revisions:		
No.	Description	Date

**Department of
Community
Development**

Office No. 972-219-3490
Fax No. 972-219-3487
www.cityoflewisville.com

Dated: 4-27-10

Sheet: **3.5b**

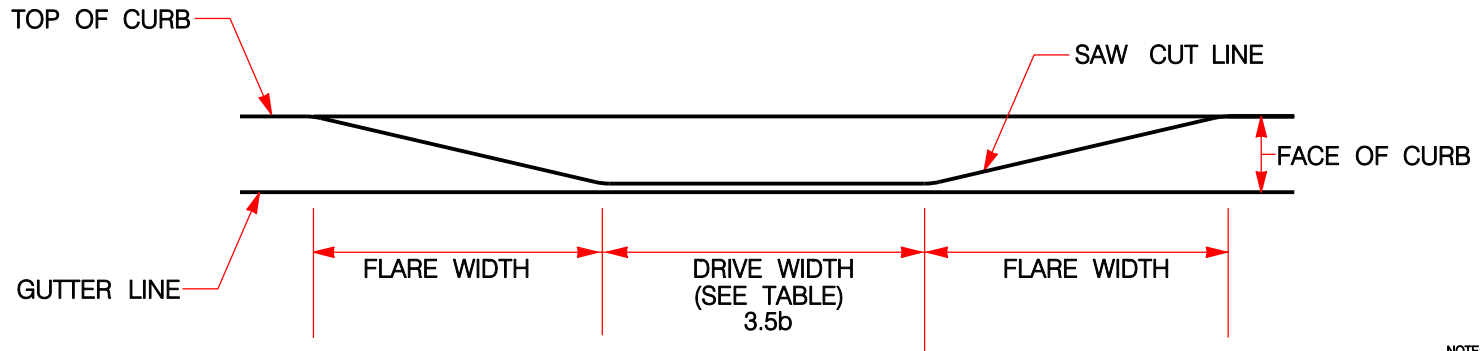
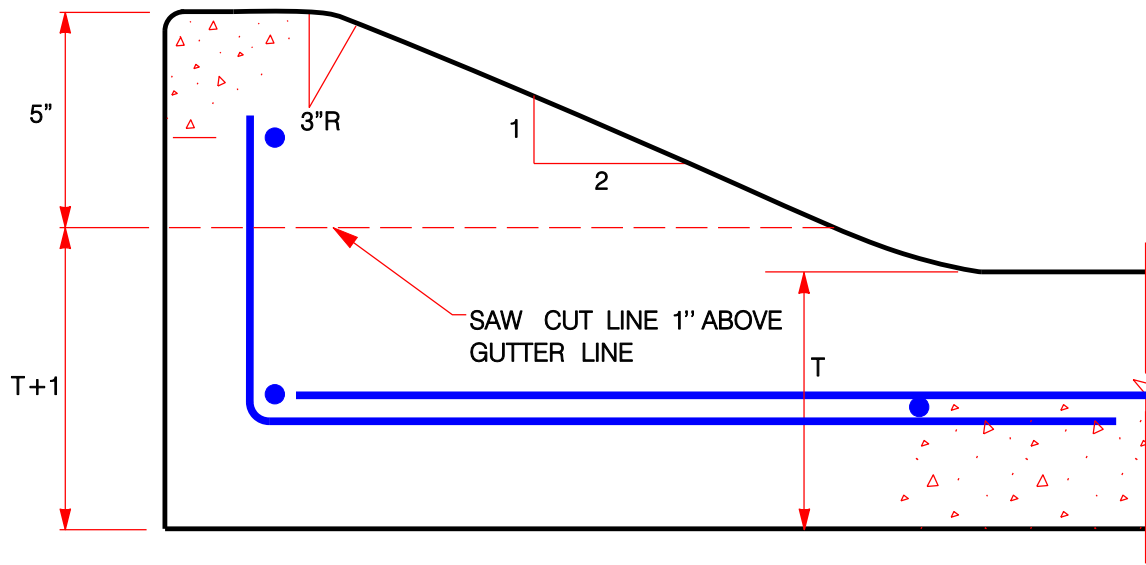

NOTE:
 DETAIL SUBJECT TO CHANGE PER DIRECTION
 OF CITY OF LEWISVILLE ENGINEERING DIVISION.



Standard Details
6" INTEGRAL
SURMOUNTABLE CURB SAWING DETAIL

Revisions:		
No.	Description	Date

**Department of
 Community
 Development**

Office No. 972-219-3490
 Fax No. 972-219-3487
 www.cityoflewisville.com

Dated: 8-13-07

Sheet:
3.5c

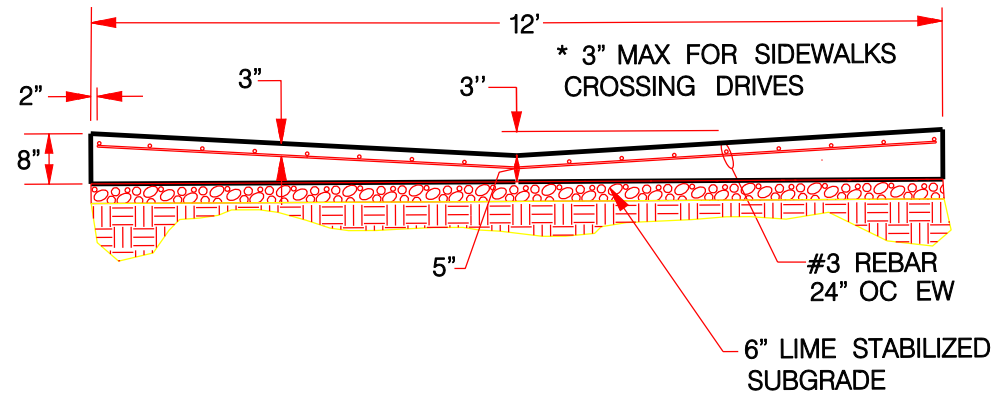
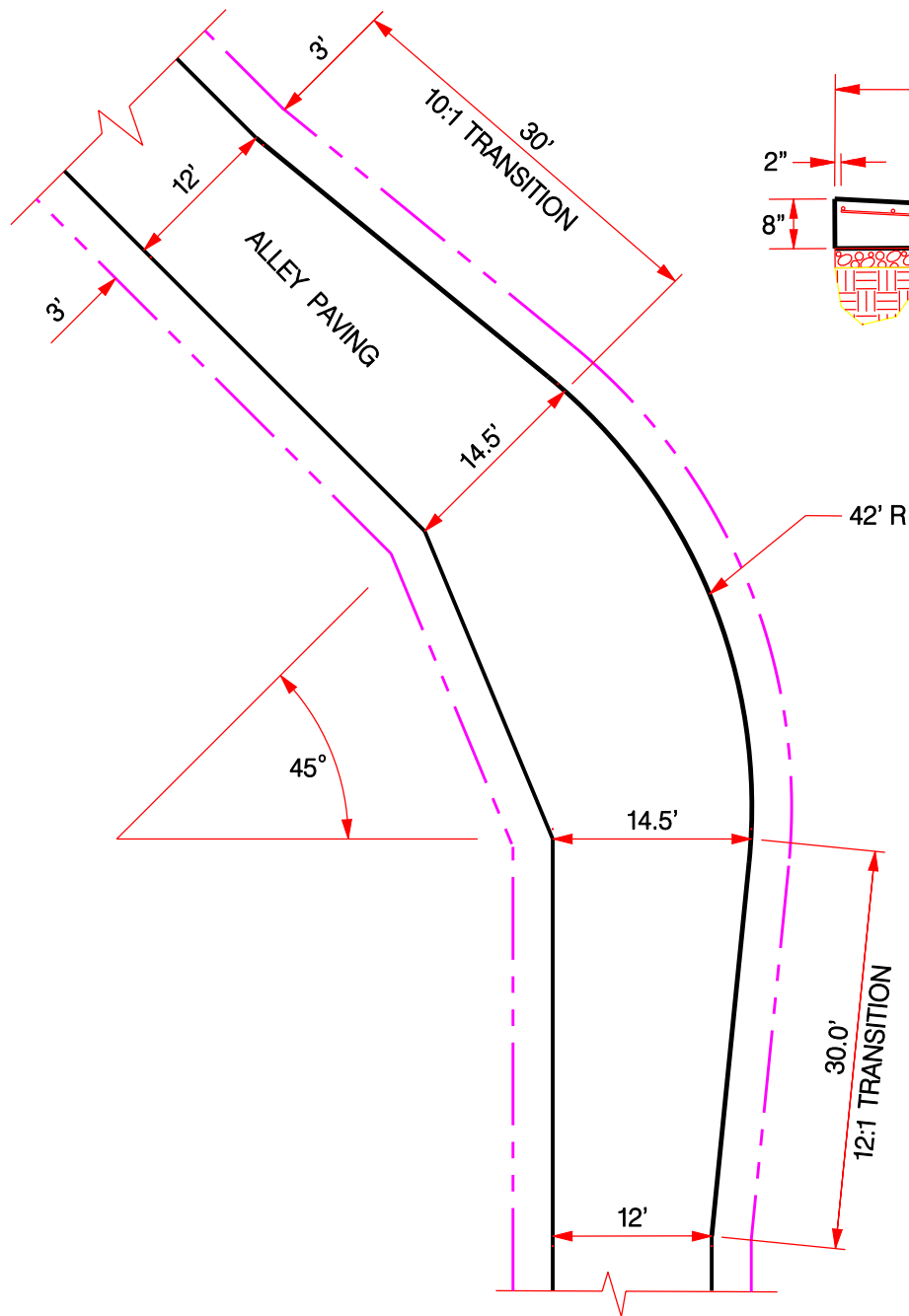

NOTE:
 DETAIL SUBJECT TO CHANGE PER DIRECTION
 OF CITY OF LEWISVILLE ENGINEERING DIVISION.



Standard Details
 Residential Alley Intersection
 (45°)

Revisions:

No.	Description	Date

Department of
 Community
 Development

Office No. 972-219-3490
 Fax No. 972-219-3487
 www.cityoflewisville.com

Dated: 4-27-10

Sheet:
 3.6

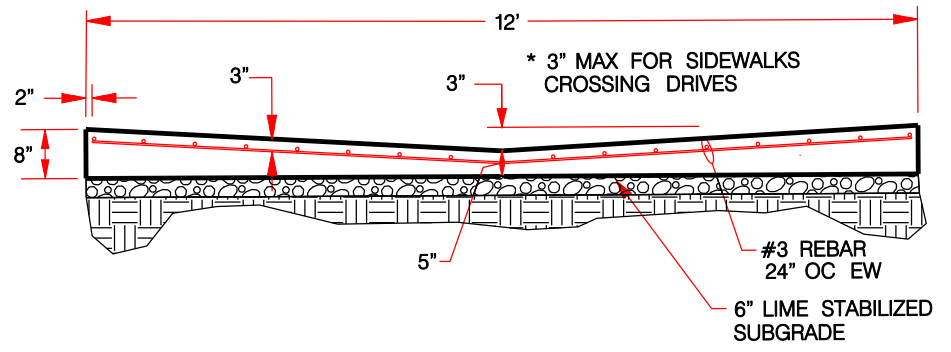
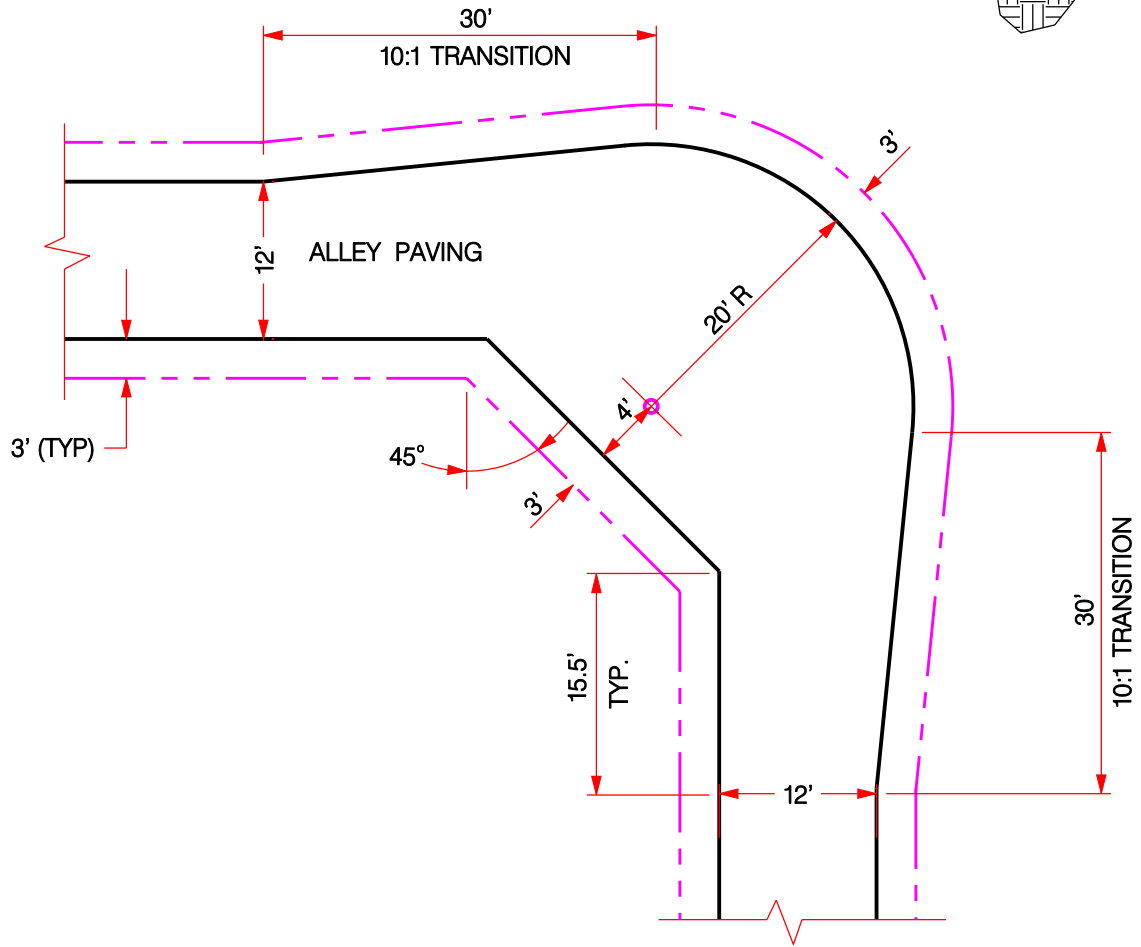

NOTE:
 DETAIL SUBJECT TO CHANGE PER DIRECTION
 OF CITY OF LEWISVILLE ENGINEERING DIVISION.



Standard Details
 Residential Alley Intersection
 (90°)

Revisions:		
No.	Description	Date

Department of
 Community
 Development

Office No. 972-219-3490
 Fax No. 972-219-3487
 www.cityoflewisville.com

Dated: 8-13-07

Sheet:
3.7

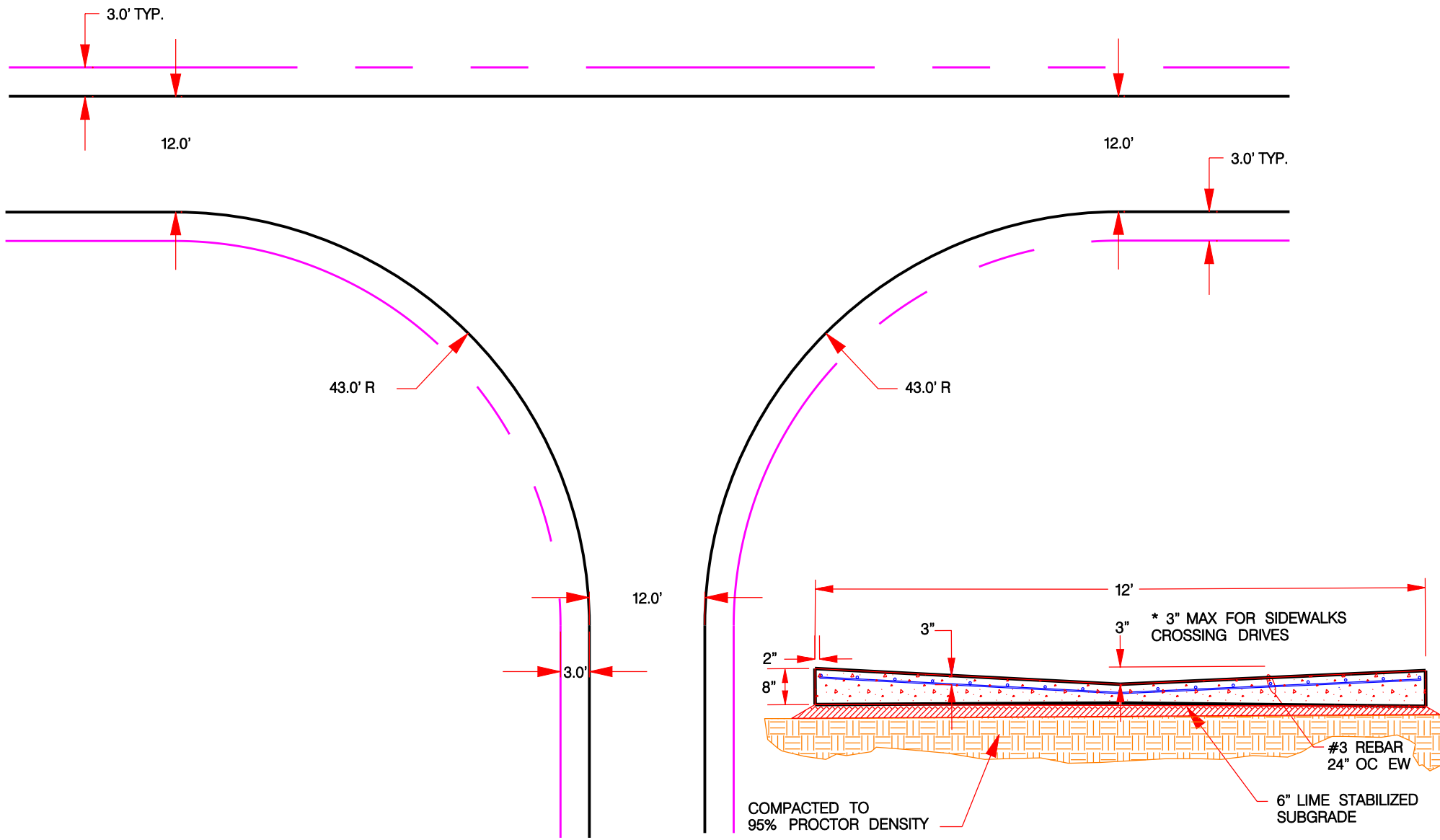

NOTE:
 DETAIL SUBJECT TO CHANGE PER DIRECTION
 OF CITY OF LEWISVILLE ENGINEERING DIVISION.



Standard Details
 Alley "T" Intersection

2240

Revisions:

No.	Description	Date

Department of
 Community
 Development

Office No. 972-219-3490
 Fax No. 972-219-3487
 www.cityoflewisville.com

Dated: 4-27-10
 Sheet:
 3.8

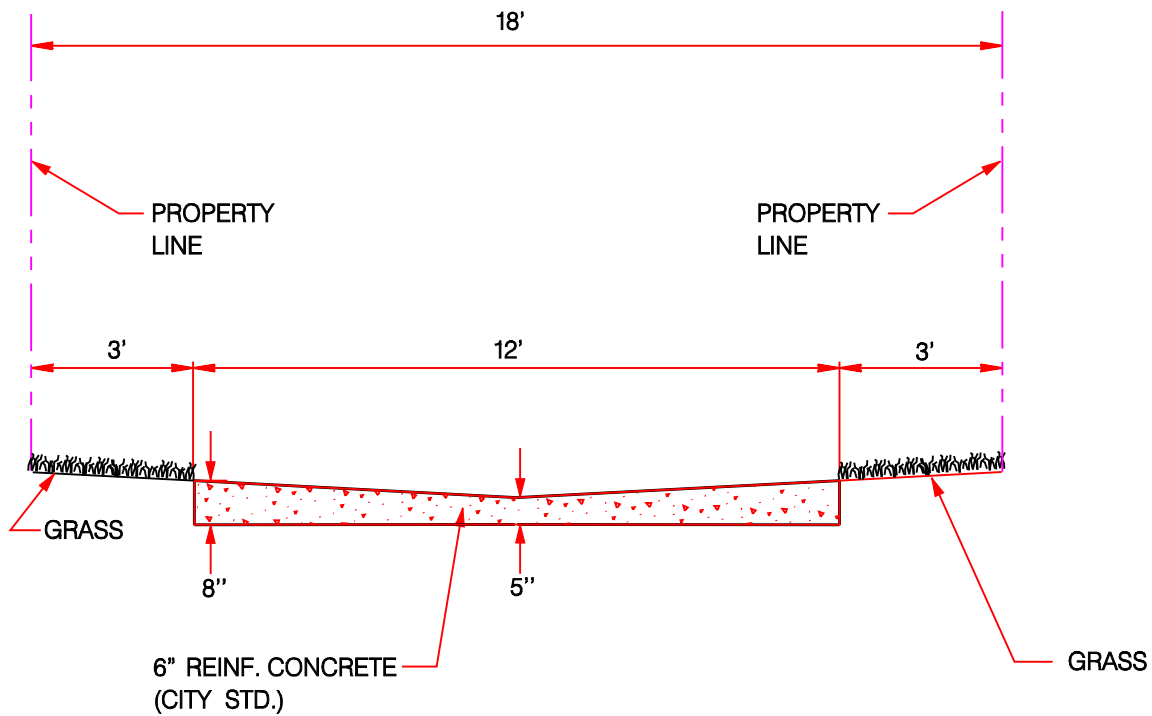

NOTE:
 DETAIL SUBJECT TO CHANGE PER DIRECTION
 OF CITY OF LEWISVILLE ENGINEERING DIVISION.



Standard Details

Standard Residential Alley

Revisions:		
No.	Description	Date

Department of
 Community
 Development

Office No. 972-219-3490
 Fax No. 972-219-3487
 www.cityoflewisville.com

Dated: 8-13-07

Sheet: 3.10

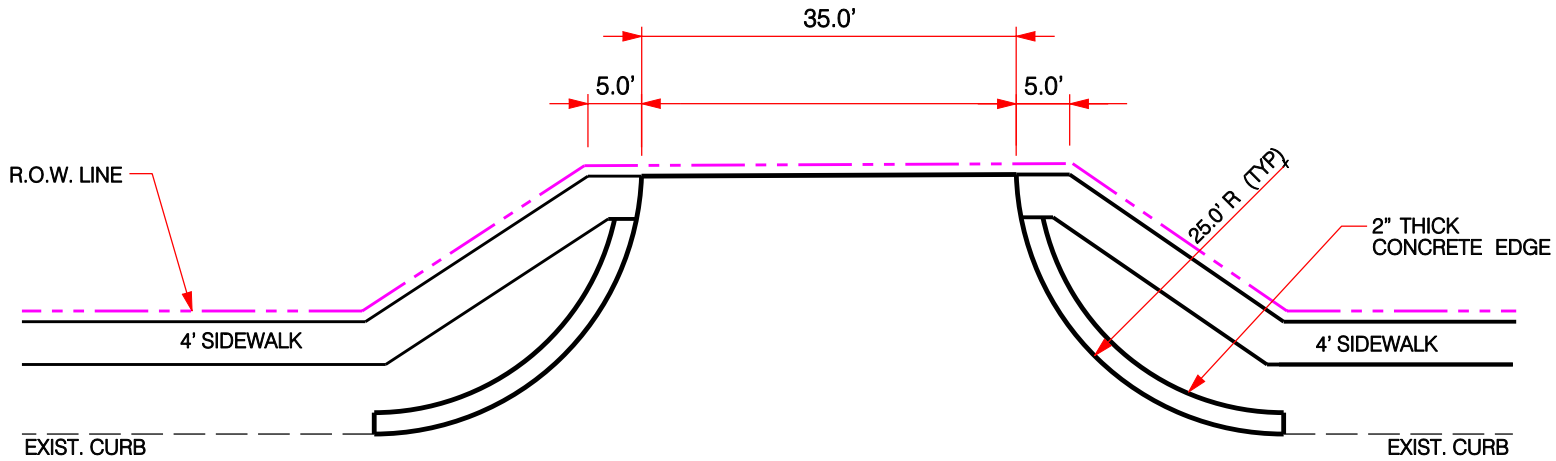

Plan View

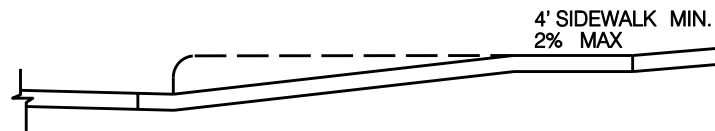

DRIVEWAY SLOPE MAX 8% EXCLUSIVE OF SIDEWALK

Profile View

NOTE:
DETAIL SUBJECT TO CHANGE PER DIRECTION
OF CITY OF LEWISVILLE ENGINEERING DIVISION.



Standard Details

Driveway Layout – Truck Entrance
Commercial and Industrial Sites

Revisions:

No.	Description	Date

Department of
Community
Development

Office No. 972-219-3490
Fax No. 972-219-3487
www.cityoflewisville.com

Dated: 4-27-10

Sheet:
3.11