

**SECTION "A-A"**

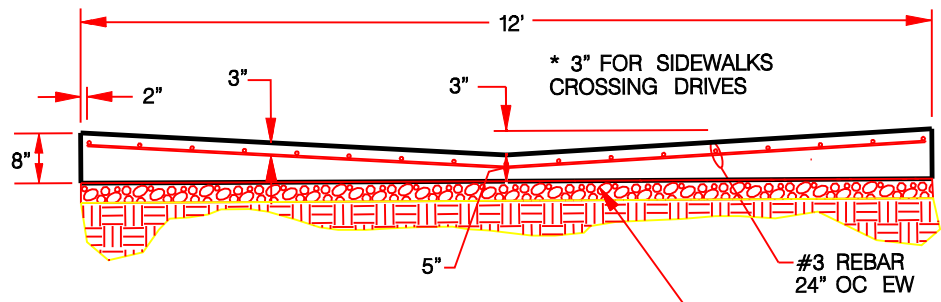

**SECTION "B-B"**

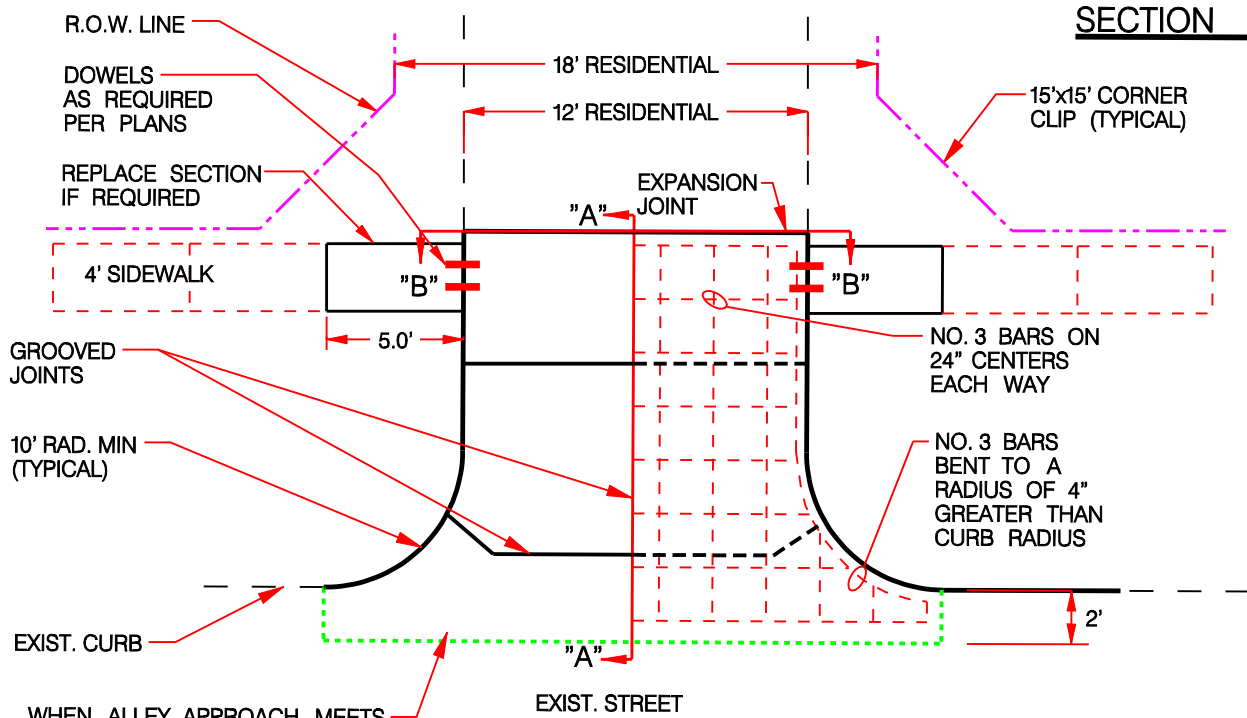

**PLAN VIEW**

NOTE:  
DETAIL SUBJECT TO CHANGE PER DIRECTION  
OF CITY OF LEWISVILLE ENGINEERING DIVISION.



Standard Details  
Typical Alley Turnout  
onto Residential Streets

Revisions:

No.	Description	Date

Department of  
Community  
Development

Office No. 972-219-3490  
Fax No. 972-219-3487  
www.cityoflewisville.com

Dated: 8-13-07

Sheet:  
**3.1**

NOTE:

MAX SLOPE ON DRIVEWAY SHALL NOT EXCEED 8% UP TO R.O.W. LINE AND 14% BEYOND THE R.O.W. LINE.

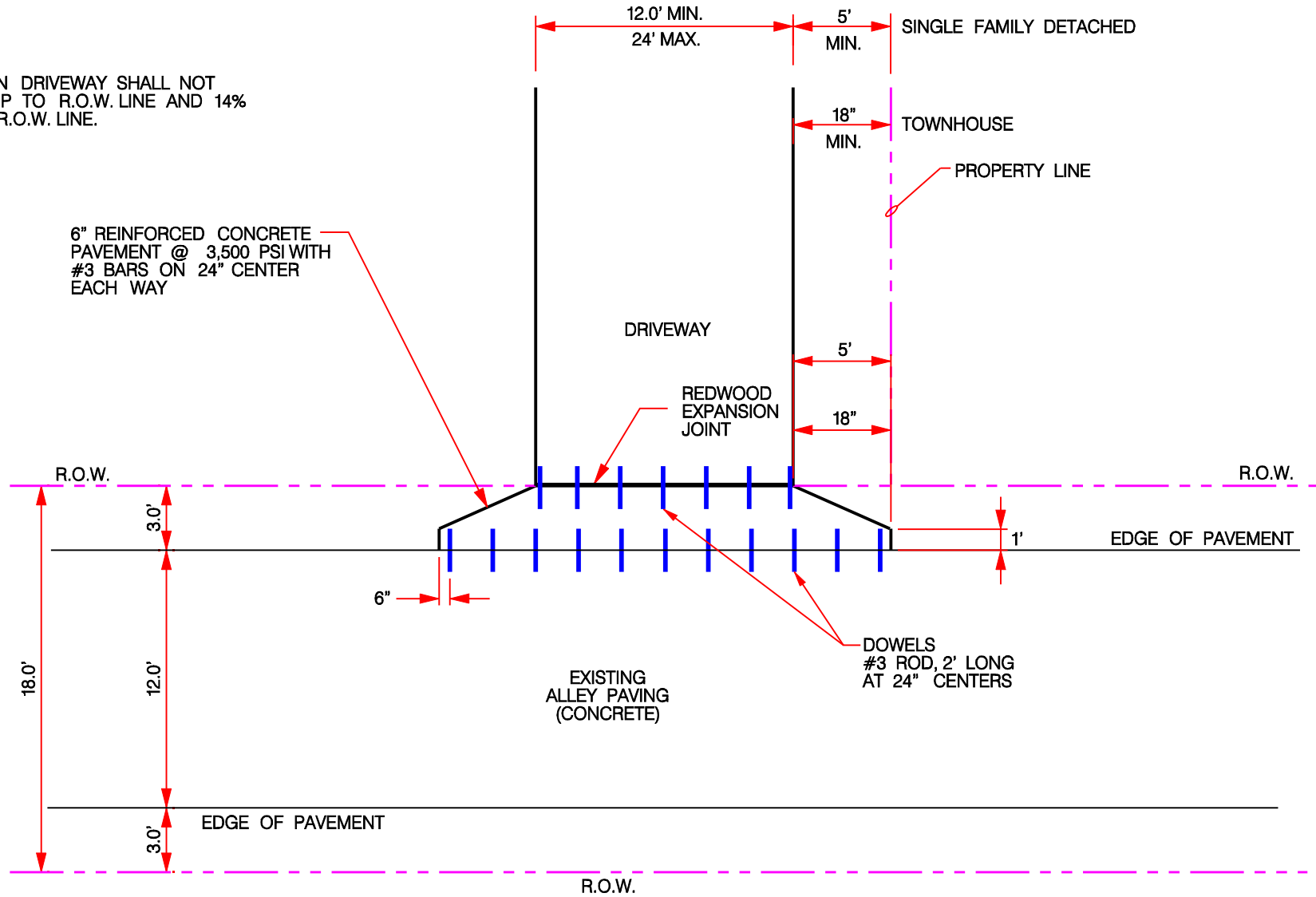

6" REINFORCED CONCRETE PAVEMENT @ 3,500 PSI WITH #3 BARS ON 24" CENTER EACH WAY

DRIVEWAY

REDWOOD EXPANSION JOINT

EXISTING ALLEY PAVING (CONCRETE)

DOWELS #3 ROD, 2' LONG AT 24" CENTERS

NOTE: DETAIL SUBJECT TO CHANGE PER DIRECTION OF CITY OF LEWISVILLE ENGINEERING DIVISION.



Standard Details  
Residential Driveway Connection  
(To Alley)

Revisions:		
No.	Description	Date

Department of Community Development  
Office No. 972-219-3490  
Fax No. 972-219-3487  
www.cityoflewisville.com

Dated: 8-13-07  
Sheet: 3.2

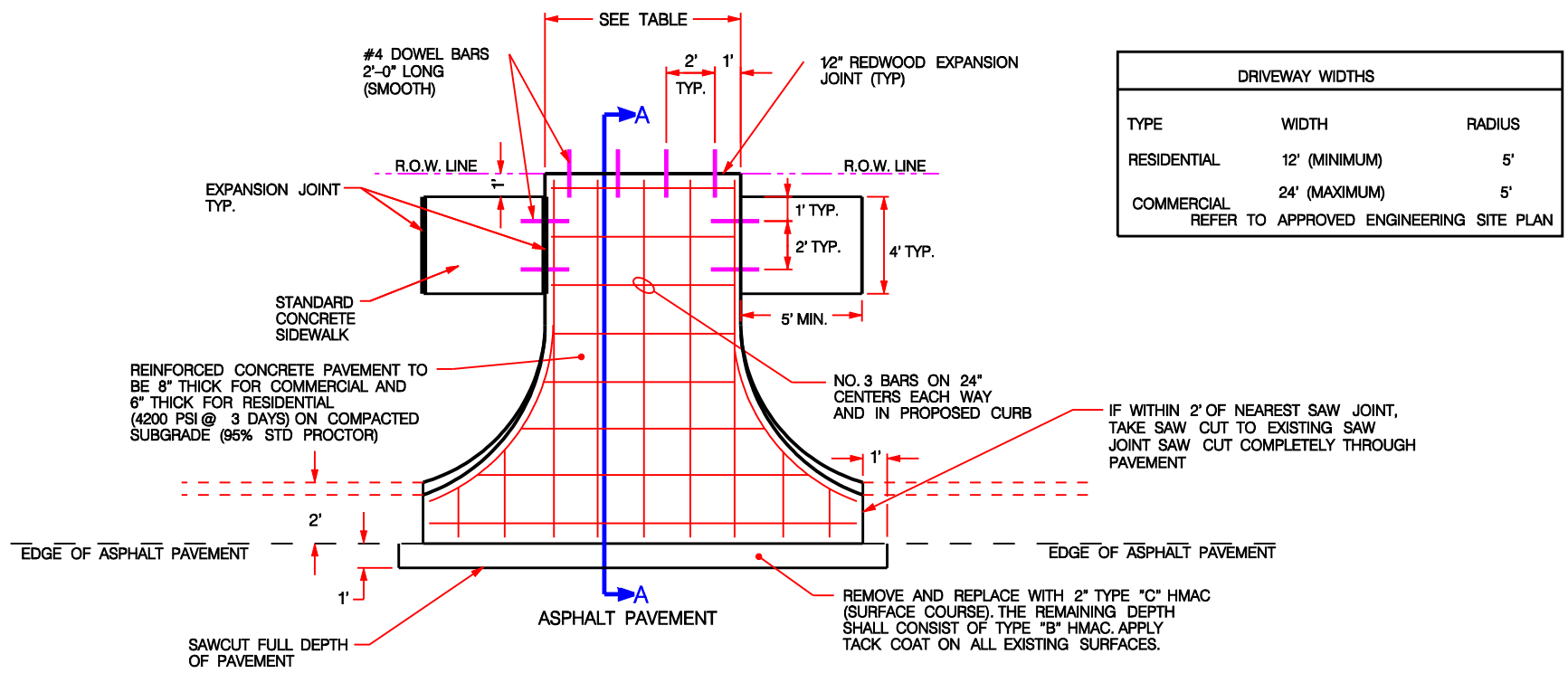

DRIVEWAY WIDTHS		
TYPE	WIDTH	RADIUS
RESIDENTIAL	12' (MINIMUM)	5'
COMMERCIAL	24' (MAXIMUM)	5'
REFER TO APPROVED ENGINEERING SITE PLAN		

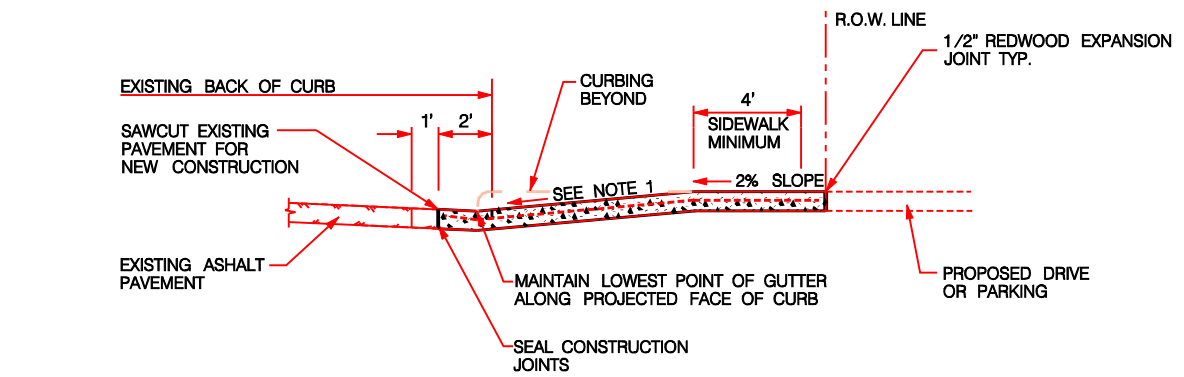

- NOTE:
1. MAXIMUM SLOPE IS 8% FOR RESIDENTIAL AND COMMERCIAL.
  2. DRIVEWAY TO BE CONSTRUCTED WITHIN 5 DAYS OF SAWCUTTING PAVEMENT.

A-A SECTION THROUGH DRIVE APPROACH

NOTE:  
DETAIL SUBJECT TO CHANGE PER DIRECTION  
OF CITY OF LEWISVILLE ENGINEERING DIVISION.



## Standard Details

### Driveway Paving Detail

(Concrete Drive with Asphalt Pavement)

Revisions:		
No.	Description	Date

Department of  
Community  
Development

Office No. 972-219-3490  
Fax No. 972-219-3487  
www.cityoflewisville.com

Dated: 8-13-07

Sheet:  
**3.3**

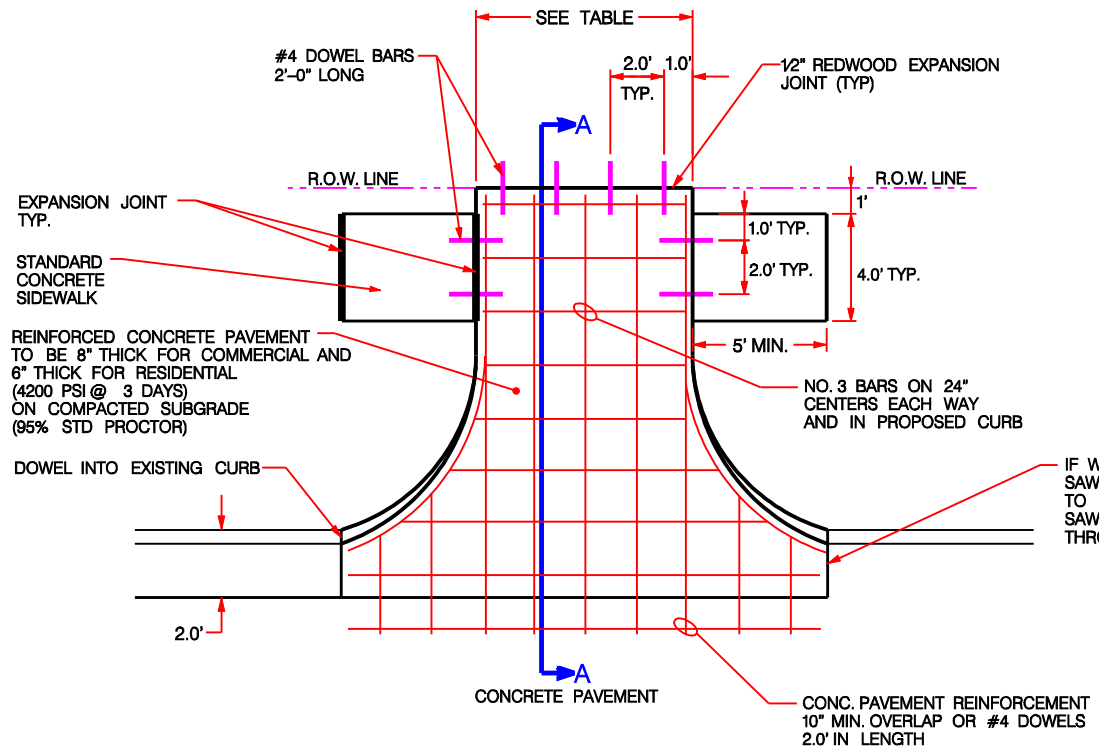

DRIVEWAY WIDTHS		
TYPE	WIDTH	RADIUS
RESIDENTIAL	12' (MINIMUM)	5'
	24' (MAXIMUM)	5'
COMMERCIAL	REFER TO APPROVED ENGINEERING SITE PLAN	

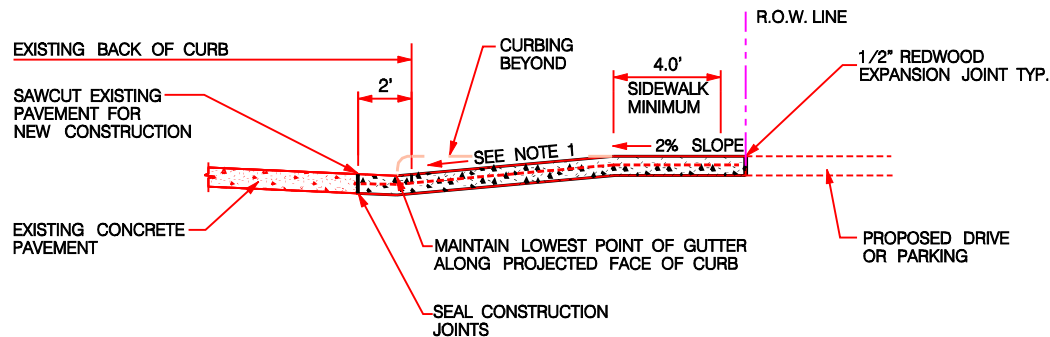

NOTE:

1. MAXIMUM SLOPE IS 8% FOR RESIDENTIAL AND 8% FOR COMMERCIAL
2. DRIVEWAY TO BE CONSTRUCTED WITHIN 5 DAYS OF SAW CUTTING PAVEMENT

A-A SECTION  
CONCRETE DRIVE APPROACH

NOTE:  
DETAIL SUBJECT TO CHANGE PER DIRECTION  
OF CITY OF LEWISVILLE ENGINEERING DIVISION.



## Standard Details

### Driveway Paving Detail

(Concrete Drive with Concrete Pavement)

Revisions:

No.	Description	Date

Department of  
Community  
Development

Office No. 972-219-3490  
Fax No. 972-219-3487  
www.cityoflewisville.com

Dated: 8-13-07

Sheet:  
**3.4**

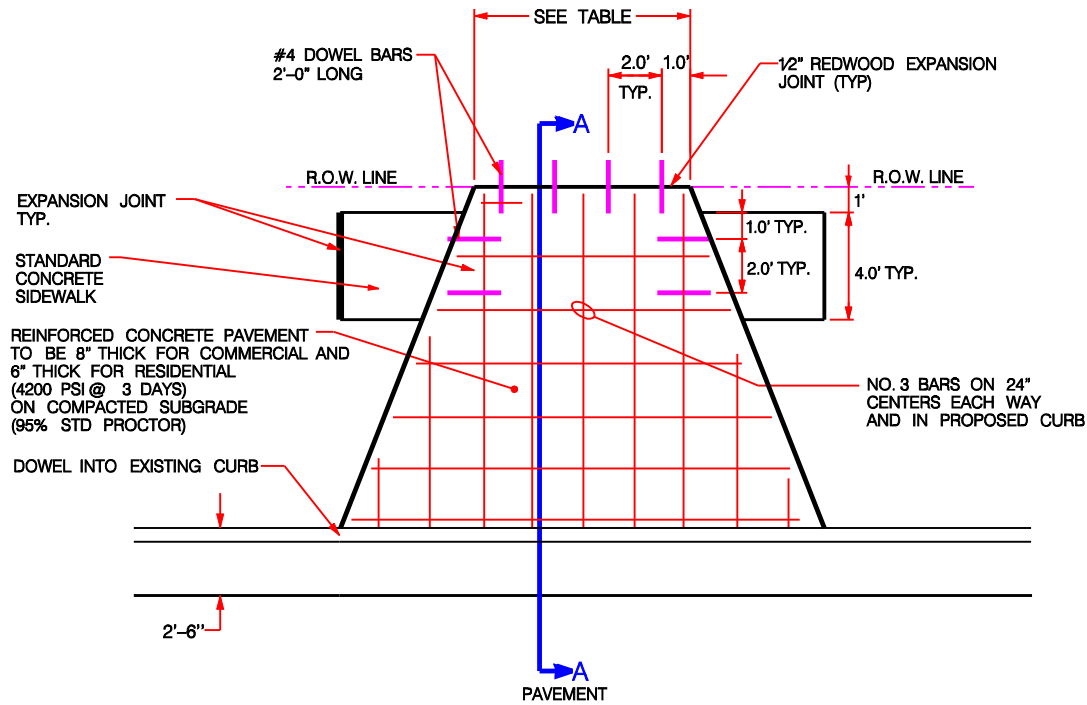

DRIVEWAY WIDTHS		
TYPE	WIDTH	FLARE
SINGLE FAMILY	12' (MINIMUM)	
DETACHED	24' (MAXIMUM)	5' 5'
TOWNHOUSE	12' (MINIMUM)	18"
COMMERCIAL	24' (MAXIMUM)	18"
REFER TO APPROVED ENGINEERING SITE PLAN		

REINFORCED CONCRETE PAVEMENT TO BE 8" THICK FOR COMMERCIAL AND 6" THICK FOR RESIDENTIAL (4200 PSI @ 3 DAYS) ON COMPACTED SUBGRADE (95% STD PROCTOR)

NO. 3 BARS ON 24" CENTERS EACH WAY AND IN PROPOSED CURB

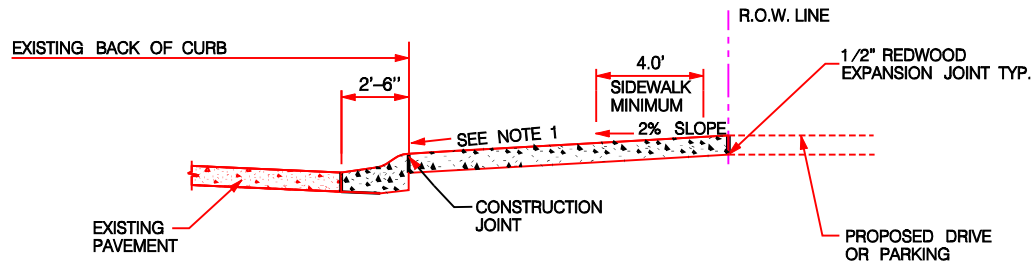

NOTE:  
1. MAXIMUM SLOPE IS 8% FOR RESIDENTIAL AND 8% FOR COMMERCIAL

A-A SECTION  
CONCRETE DRIVE APPROACH

NOTE:  
DETAIL SUBJECT TO CHANGE PER DIRECTION OF CITY OF LEWISVILLE ENGINEERING DIVISION.



## Standard Details

### Driveway Paving Detail

(Concrete Drive with Surmountable Curb)

**Revisions:**

No.	Description	Date

Department of  
Community  
Development

Office No. 972-219-3490  
Fax No. 972-219-3487  
www.cityoflewisville.com

Dated: 8-13-07

Sheet:  
**3.5**

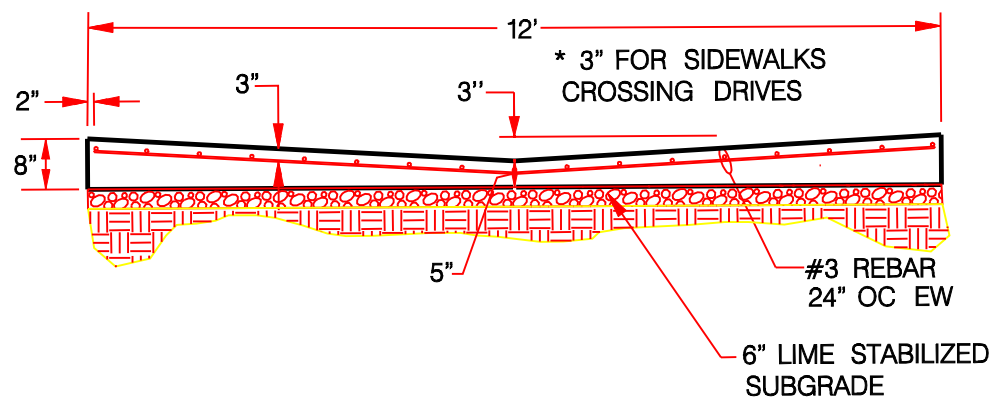
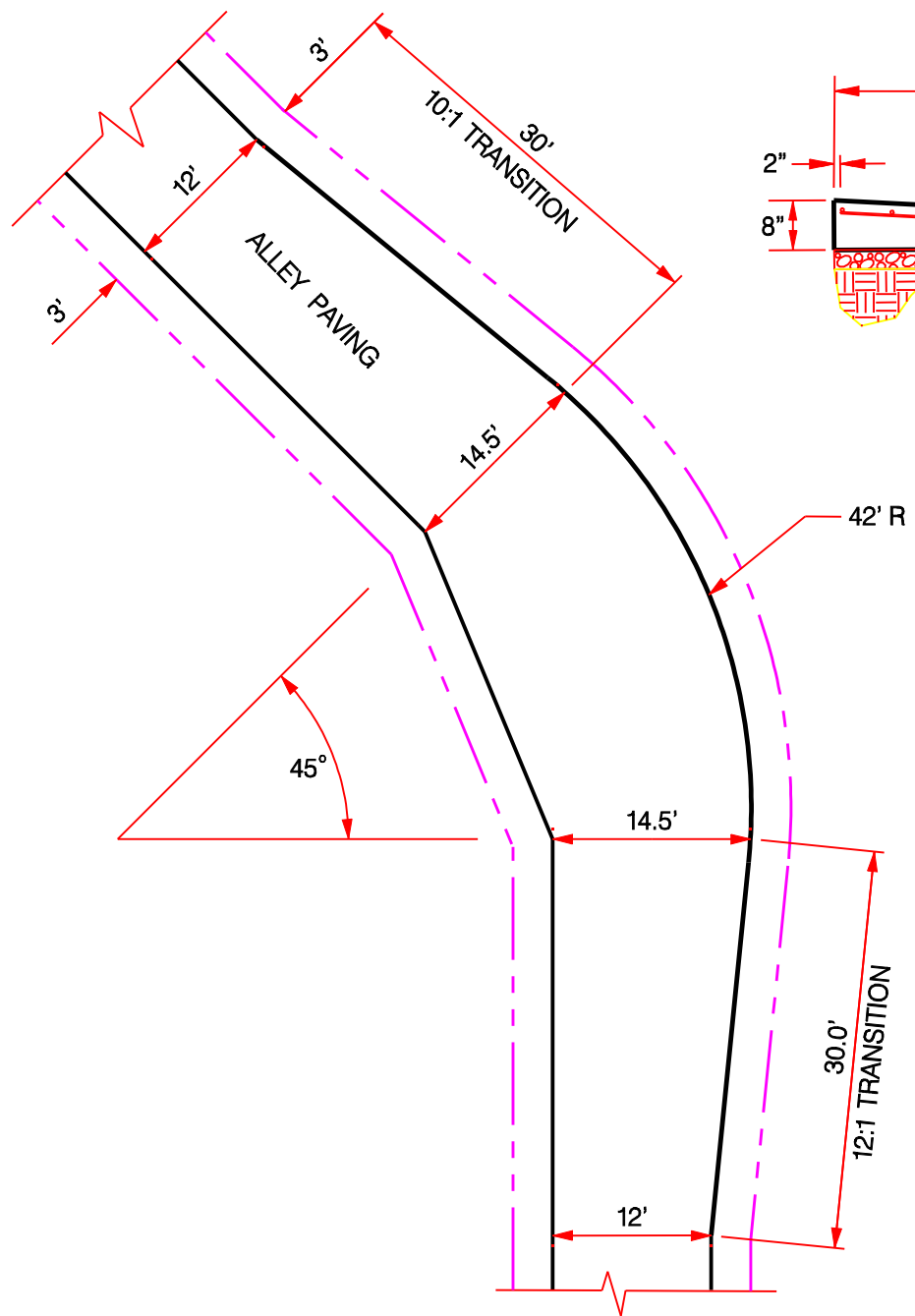

NOTE:  
 DETAIL SUBJECT TO CHANGE PER DIRECTION  
 OF CITY OF LEWISVILLE ENGINEERING DIVISION.



**Standard Details**  
 Residential Alley Intersection  
 (45°)

Revisions:

No.	Description	Date

Department of  
 Community  
 Development

Office No. 972-219-3490  
 Fax No. 972-219-3487  
 www.cityoflewisville.com

Dated: 8-13-07

---

Sheet:  
**3.6**

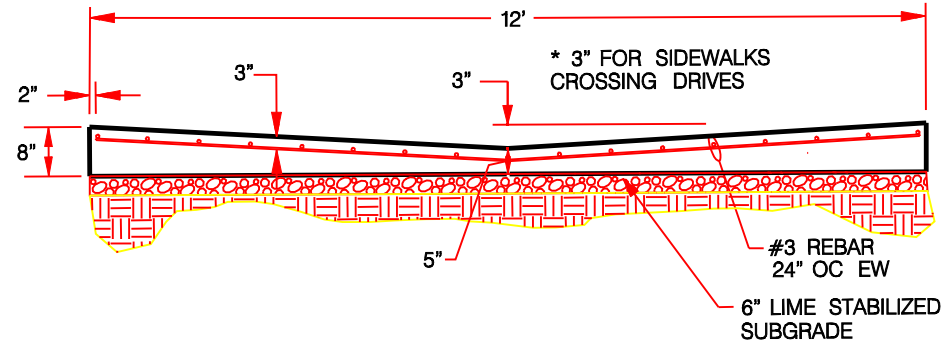
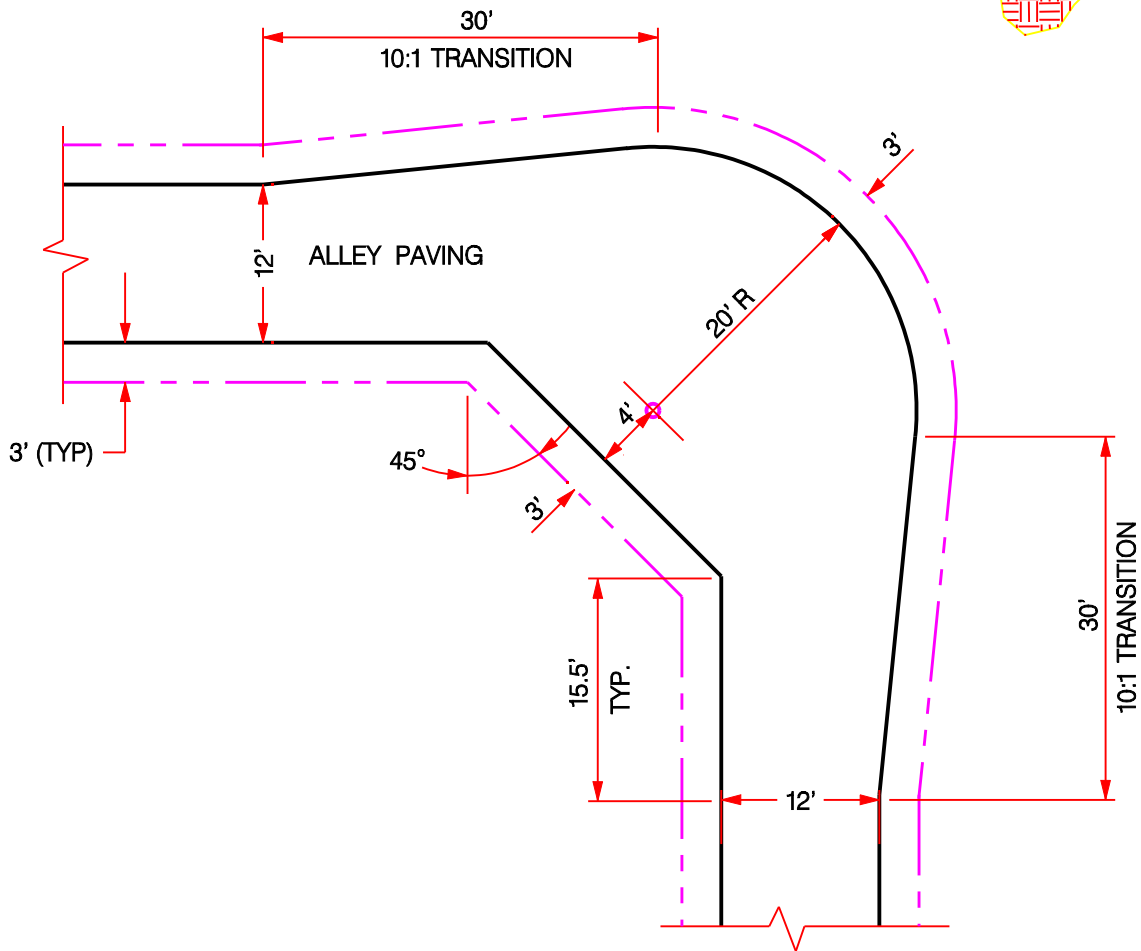

NOTE:  
 DETAIL SUBJECT TO CHANGE PER DIRECTION  
 OF CITY OF LEWISVILLE ENGINEERING DIVISION.



Standard Details  
 Residential Alley Intersection  
 (90°)

Revisions:		
No.	Description	Date

Department of  
 Community  
 Development

Office No. 972-219-3490  
 Fax No. 972-219-3487  
 www.cityoflewisville.com

Dated: 8-13-07

Sheet:  
**3.7**

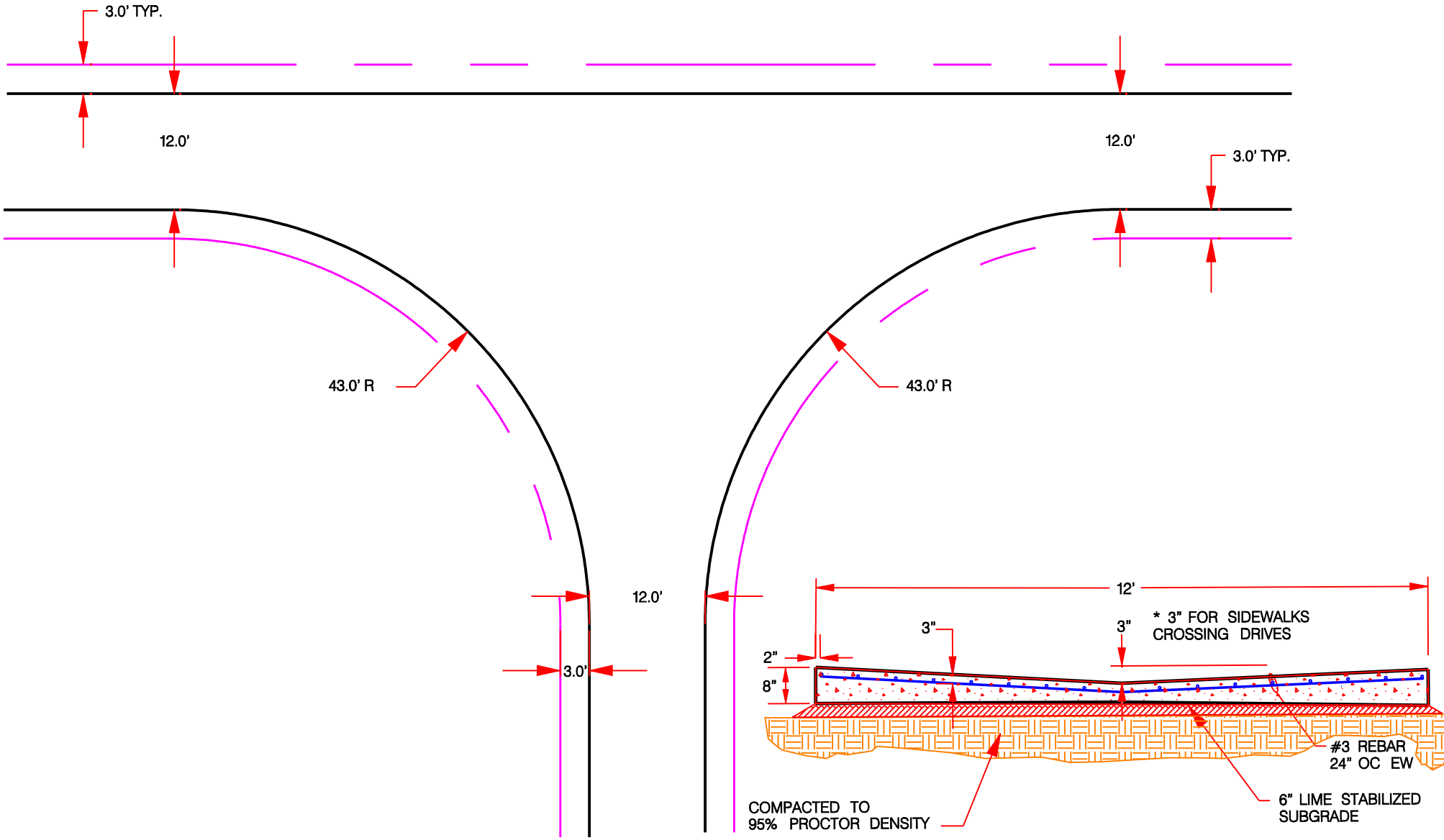

NOTE:  
DETAIL SUBJECT TO CHANGE PER DIRECTION  
OF CITY OF LEWISVILLE ENGINEERING DIVISION.



# Standard Details

## Alley "T" Intersection

2240

Revisions:		
No.	Description	Date

Department of  
Community  
Development

Office No. 972-219-3490  
Fax No. 972-219-3487  
www.cityoflewisville.com

Dated: 8-13-07

Sheet:  
**3.8**

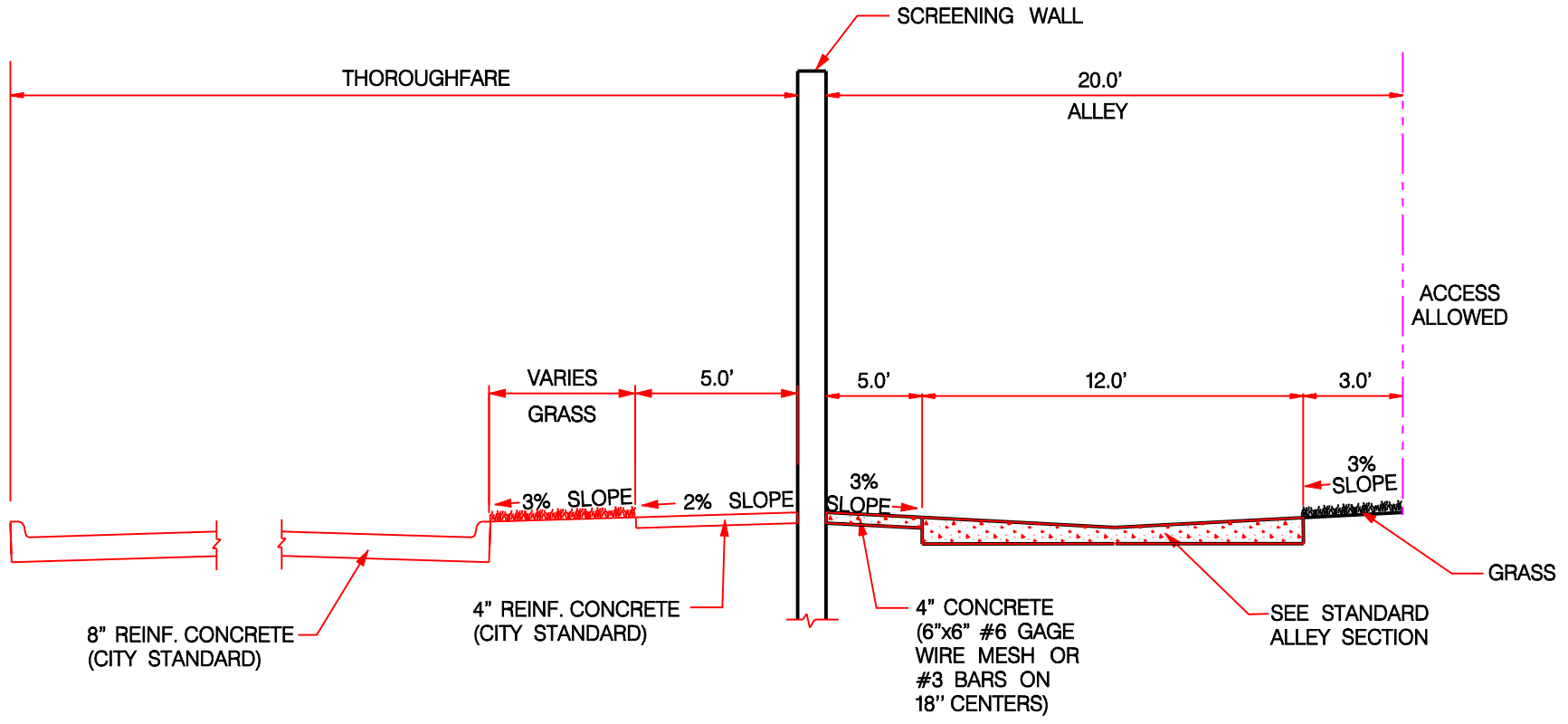

NOTE:  
 DETAIL SUBJECT TO CHANGE PER DIRECTION  
 OF CITY OF LEWISVILLE ENGINEERING DIVISION.



Standard Details  
 Residential Alley

Revisions:

No.	Description	Date

Department of  
 Community  
 Development

Office No. 972-219-3490  
 Fax No. 972-219-3487  
 www.cityoflewisville.com

Dated: 8-13-07

Sheet: **3.9**

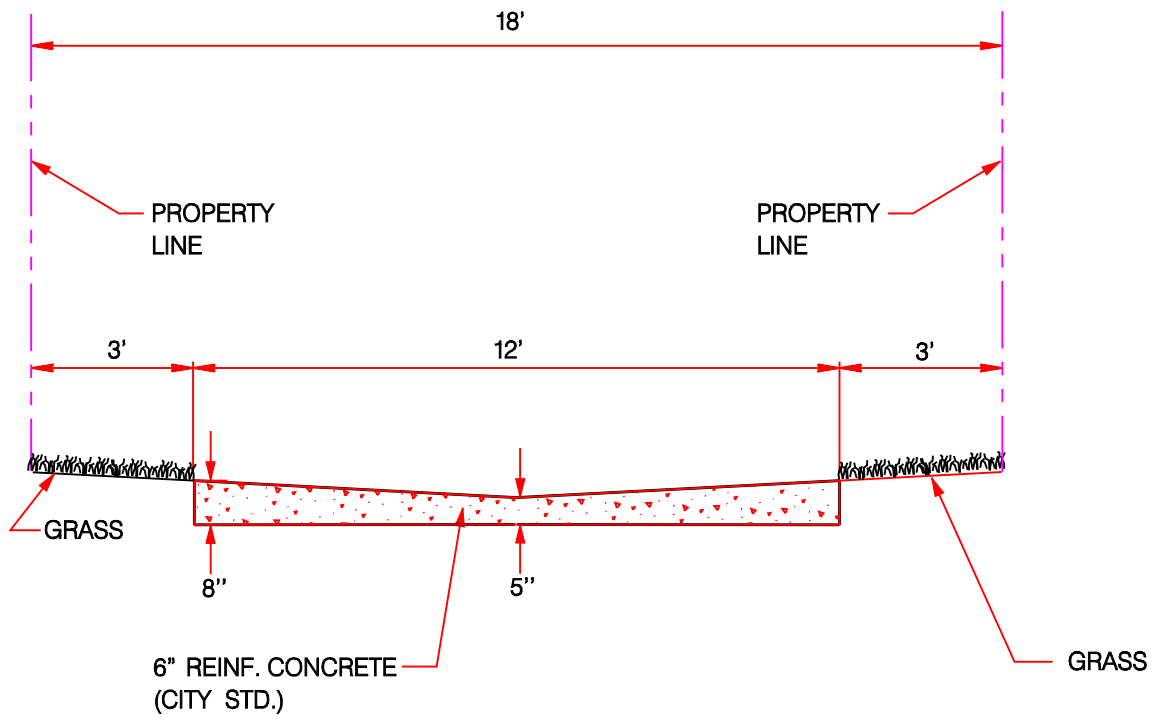

NOTE:  
 DETAIL SUBJECT TO CHANGE PER DIRECTION  
 OF CITY OF LEWISVILLE ENGINEERING DIVISION.



Standard Details

Standard Residential Alley

Revisions:

No.	Description	Date

Department of  
 Community  
 Development

Office No. 972-219-3490  
 Fax No. 972-219-3487  
 www.cityoflewisville.com

Dated: 8-13-07

Sheet: 3.10

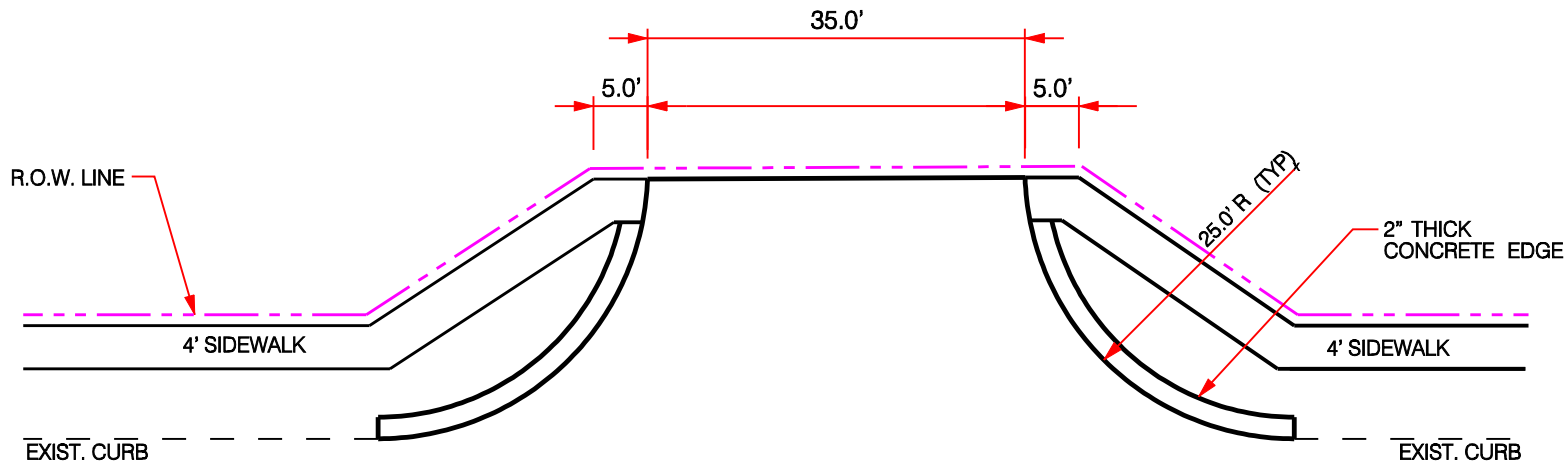

Plan View

NOTE:  
 DETAIL SUBJECT TO CHANGE PER DIRECTION  
 OF CITY OF LEWISVILLE ENGINEERING DIVISION.



Standard Details  
 Driveway Layout – Truck Entrance  
 Commercial and Industrial Sites

Revisions:

No.	Description	Date

Department of  
 Community  
 Development

Office No. 972-219-3490  
 Fax No. 972-219-3487  
 www.cityoflewisville.com

Dated: 8-13-07

Sheet:  
 3.11